



MATERIAL

Knurled aluminium profile, anodised, black colour.

CAP

Acetal resin based (POM) technopolymer, light-grey colour.

HANDLE

Polyamide based (PA) technopolymer, black colour, glossy finish.

STANDARD EXECUTIONS

- **GN 736-B-A:** H8 reamed hole, without handle.
- Assembly by means of a supplied stainless steel transversal grub screw UNI 5929 (grub screw with hexagon socket and cup end).
- **GN 736-B-D:** H8 reamed hole, with revolving handle.
- Assembly by means of a supplied stainless steel transversal grub screw UNI 5929 (grub screw with hexagon socket and cup end).
- **GN 736-K-A:** H8 reamed hole and keyway in compliance with DIN 6885/1 tolerance P9 (see page A-15), without handle.
- **GN 736-K-D:** H8 reamed hole and keyway in compliance with DIN 6885/1 tolerance P9 (see page A-15), with revolving handle.

SPECIAL EXECUTIONS ON REQUEST

On the surface of the cap words, marks, graphic symbols, etc...can be tampoprinted in colours.

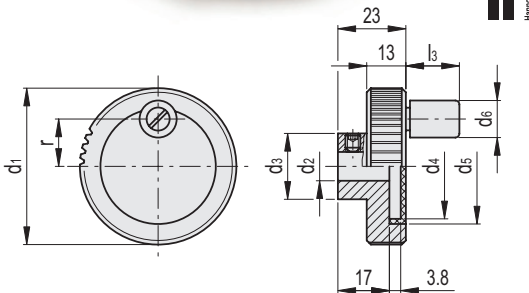

GN 736-B

Code	Description	d1	d2H8	d3	d4	d5	d6	l3	Δ
GN.19501	GN 736-52-B10-A	52	10	22	37	39.5	-	-	56
GN.19502	GN 736-52-B10-D	52	10	22	37	39.5	13	19	69
GN.19511	GN 736-62-B10-A	62	10	25	47	49.5	-	-	76
GN.19512	GN 736-62-B10-D	62	10	25	47	49.5	14	21	90

GN 736-K

GN.19505	GN 736-52-K10-A	52	10	22	37	39.5	-	-	55
GN.19506	GN 736-52-K10-D	52	10	22	37	39.5	13	19	68
GN.19515	GN 736-62-K10-A	62	10	25	47	49.5	-	-	75
GN.19516	GN 736-62-K10-D	62	10	25	47	49.5	14	21	89



MATERIAL

Knurled aluminium profile, anodised, black colour.

CAP

Acetal resin based (POM) technopolymer, light-grey colour.

HANDLE

Polyamide based (PA) technopolymer, black colour, glossy finish.

STANDARD EXECUTIONS

- **GN 736.1-B-A:** H8 reamed hole, without handle.
- **GN 736.1-B-D:** H8 reamed hole, with revolving handle.
- **GN 736.1-K-A:** H8 reamed hole and keyway in compliance with DIN 6885/1 tolerance P9 (see page A-15), without handle.
- **GN 736.1-K-D:** H8 reamed hole and keyway in compliance with DIN 6885/1 tolerance P9 (see page A-15), with revolving handle.

SPECIAL EXECUTIONS ON REQUEST

- On the surface of the cap words, marks, graphic symbols, etc...can be tampoprinted in colours.
- On the plain surface of the handwheel precision graduations can be laser-engraved (see Graduations on page 611).

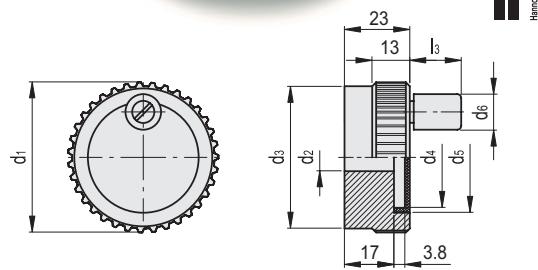

GN 736.1-B

Code	Description	d1	d2H8	d3	d4	d5	d6	l3	Δ
GN.19551	GN 736.1-52-B10-A	52	10	50	37	39.5	-	-	100
GN.19552	GN 736.1-52-B10-D	52	10	50	37	39.5	13	19	113
GN.19561	GN 736.1-62-B10-A	62	10	60	47	49.5	-	-	142
GN.19562	GN 736.1-62-B10-D	62	10	60	47	49.5	14	21	156

GN 736.1-K

GN.19555	GN 736.1-52-K10-A	52	10	50	37	39.5	-	-	99
GN.19556	GN 736.1-52-K10-D	52	10	50	37	39.5	13	19	112
GN.19565	GN 736.1-62-K10-A	62	10	60	47	49.5	-	-	141
GN.19566	GN 736.1-62-K10-D	62	10	60	47	49.5	14	21	155

